

- Combined sewer service area discharging to the LDW
- Greater LDW surface drainage basin
- Diagonal Ave S CSO/SD
- Norfolk SD
- Slip 4
- 7th Ave S SD
- West side public SDs
- Hamm Creek
- Central KCIA
- South KCIA
- Remaining east side public SDs
- S 96th St SD
- Glacier Bay/SW Kenny SD
- Private waterfront drains
- Road
- Creek
- City boundary

Map 2-1. Greater LDW drainage basins as presented in Map 9-1 of the LDW RI

Windward
environmental^{LLC}

Lower Duwamish Waterway Group
Port of Seattle / City of Seattle / King County / The Boeing Company

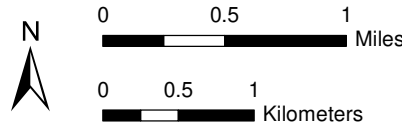

Prepared by CEH, 07/15/2010, MAP 2847, W:\Projects\00\08\06_Duwamish_RI\Map\Phase2_RI\Source_Corridor\Section 3

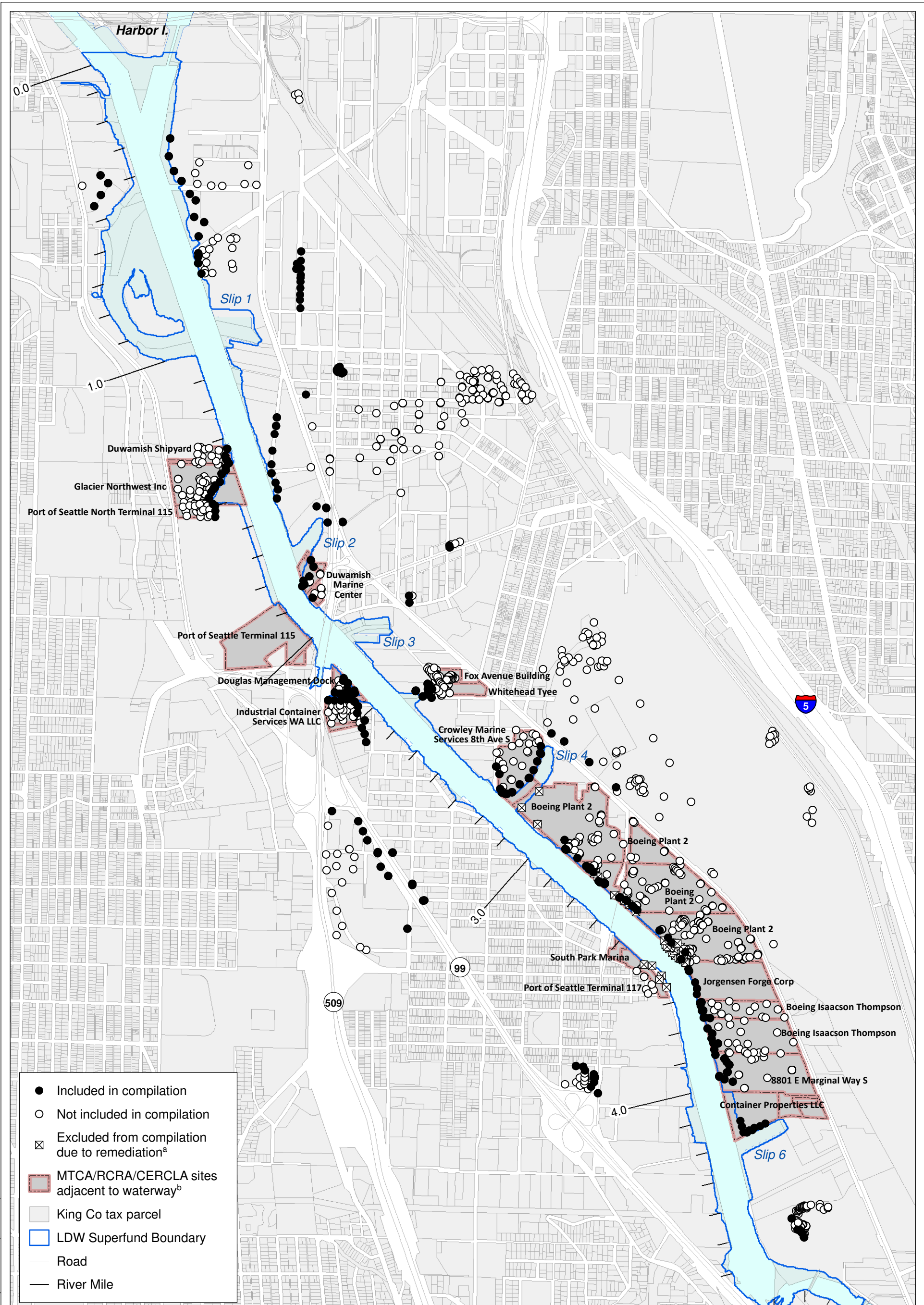

- Included in compilation
- Not included in compilation
- ⊠ Excluded from compilation due to remediation^a
- ▭ MTCA/RCRA/CERCLA sites adjacent to waterway^b
- ▭ King Co tax parcel
- ▭ LDW Superfund Boundary
- Road
- River Mile

^a Remediation status as reported for Boeing Plant 2 and T-117.
^b LDW TCP cleanup sites and EPA led cleanup sites as listed by WA Dept of Ecology Toxics Cleanup Program, 2018-01-11: <https://ecology.wa.gov/Spills-Cleanup/Contamination-cleanup/Cleanup-sites/Toxic-cleanup-sites/Lower-Duwamish-Waterway>. Note that negotiations for South Park Marina are underway.
 Note: In keeping with the Phase 1 RI approach (Windward 2003), the compilation included groundwater data that were collected from the most recent sampling event (since 2010) and from the wells that are closest to the shoreline. Data were not included in the compilation if the area has been remediated since it was last sampled.



Lower Duwamish Waterway Group
 Port of Seattle / City of Seattle / King County / The Boeing Company



Map 2-2. Groundwater sampling locations assessed for data compilation in the Task 2 database

Prepared by: cgrah, 8/13/2018, W:\Projects\Duwamish\AC03\GIS\Maps and Analysis\Task 02 Data Compilation Memo Map 2-2 8564a Groundwater well locations.mxd

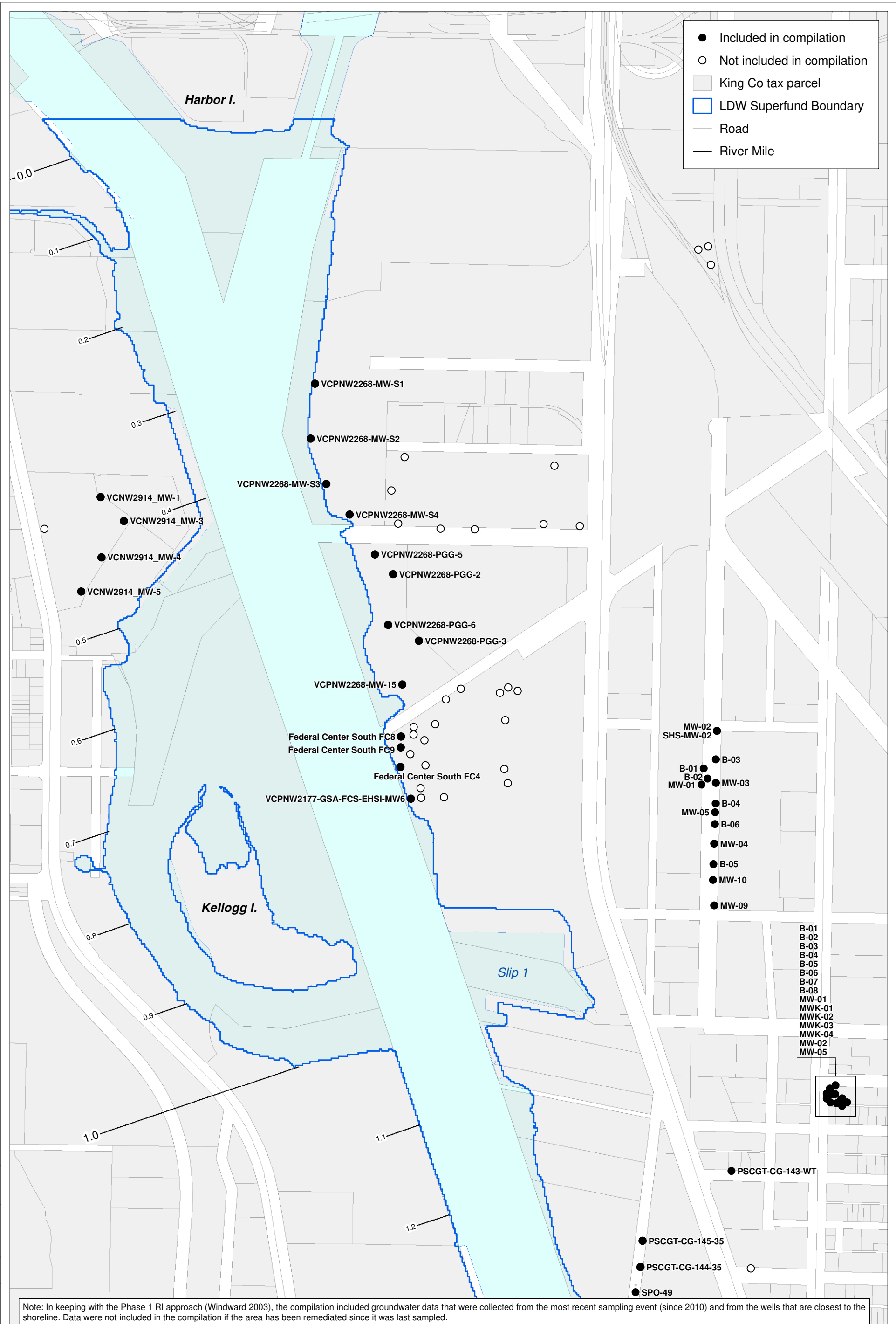

Note: In keeping with the Phase 1 RI approach (Windward 2003), the compilation included groundwater data that were collected from the most recent sampling event (since 2010) and from the wells that are closest to the shoreline. Data were not included in the compilation if the area has been remediated since it was last sampled.



Lower Duwamish Waterway Group
 Port of Seattle / City of Seattle / King County / The Boeing Company

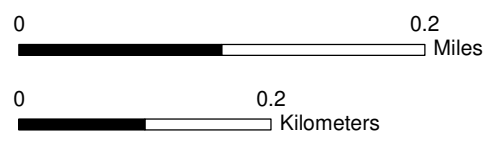

Map 2-3. Groundwater sampling locations assessed for data compilation in the Task 2 database, RM 0.0 to RM 1.2

Prepared by: cragh, 8/22/2018, W:\Projects\Duwamish_AOC3\GIS\Maps and Analyses\Task 02 Data Compilation\Memo\Map 2-3 69546_Groundwater_well_locations.mxd

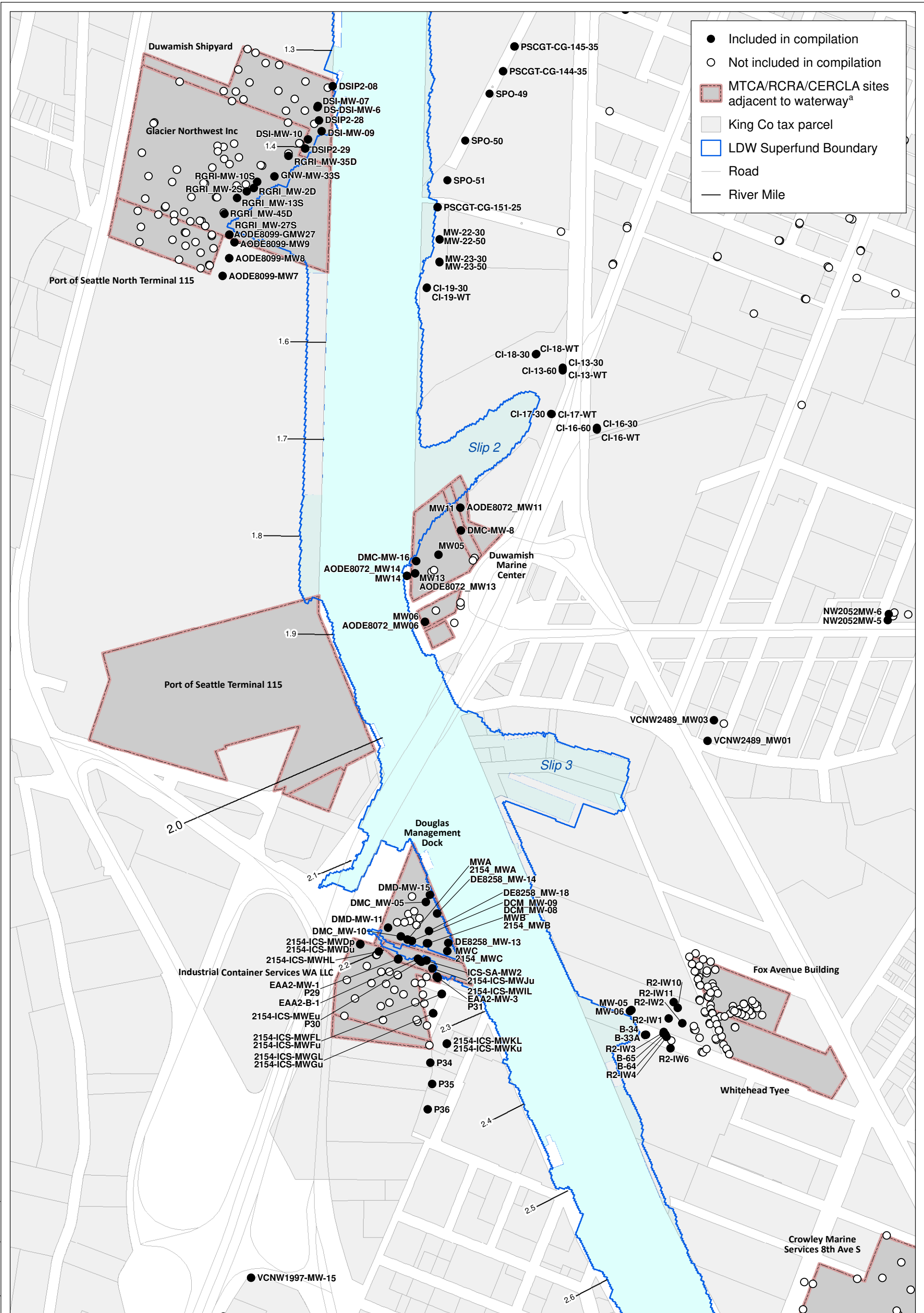

^a LDW TCP cleanup sites and EPA led cleanup sites as listed by WA Dept of Ecology Toxics Cleanup Program, 2018-01-11: <https://ecology.wa.gov/Spills-Cleanup/Contamination-cleanup/Cleanup-sites/Toxic-cleanup-sites/Lower-Duwamish-Waterway>. Note that negotiations for South Park Marina are underway.
 Note: In keeping with the Phase 1 RI approach (Windward 2003), the compilation included groundwater data that were collected from the most recent sampling event (since 2010) and from the wells that are closest to the shoreline. Data were not included in the compilation if the area has been remediated since it was last sampled.

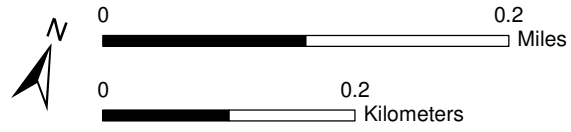

Map 2-4. Groundwater sampling locations assessed for data compilation in the Task 2 database, RM 1.2 to RM 2.6

Prepared by: crahg, 8/22/2018, W:\Projects\Duwamish_AOC3\GIS\Maps and Analyses\Task 02 Data Compilation\Memo\Map 2-4 6954c Groundwater well locations.mxd

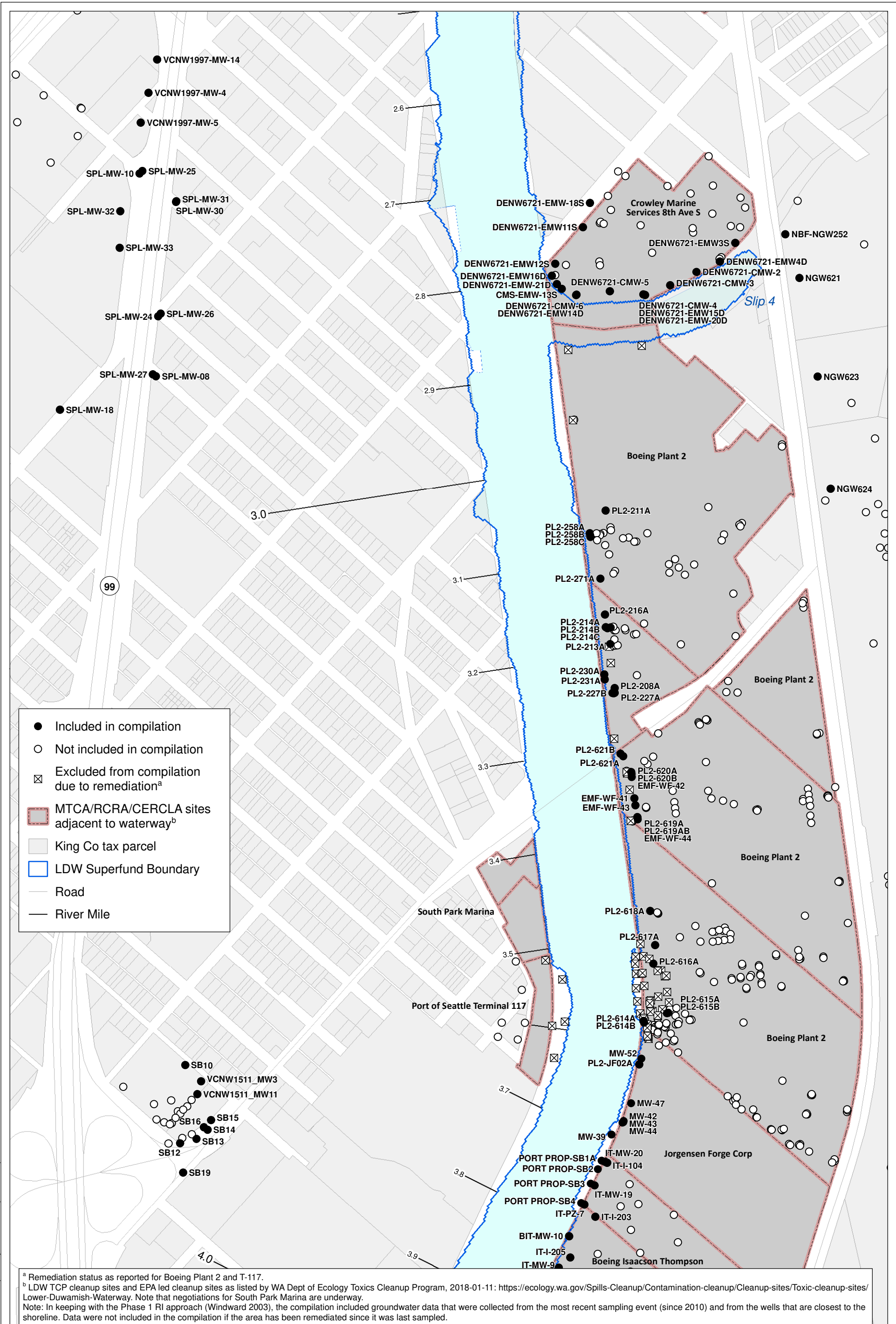

- Included in compilation
- Not included in compilation
- ⊠ Excluded from compilation due to remediation^a
- ▭ MTCA/RCRA/CERCLA sites adjacent to waterway^b
- King Co tax parcel
- LDW Superfund Boundary
- Road
- River Mile

^a Remediation status as reported for Boeing Plant 2 and T-117.
^b LDW TCP cleanup sites and EPA led cleanup sites as listed by WA Dept of Ecology Toxics Cleanup Program, 2018-01-11: <https://ecology.wa.gov/Spills-Cleanup/Contamination-cleanup/Cleanup-sites/Toxic-cleanup-sites/Lower-Duwamish-Waterway>. Note that negotiations for South Park Marina are underway.
 Note: In keeping with the Phase 1 RI approach (Windward 2003), the compilation included groundwater data that were collected from the most recent sampling event (since 2010) and from the wells that are closest to the shoreline. Data were not included in the compilation if the area has been remediated since it was last sampled.

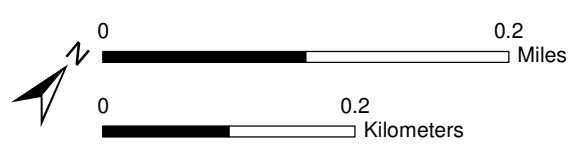

Map 2-5. Groundwater sampling locations assessed for data compilation in the Task 2 database, RM 2.6 to RM 3.8

Prepared by cragh, 8/13/2018, W:\Projects\Duwamish\AC03\GIS\Map_2-5_85645_Groundwater_well_locations.mxd

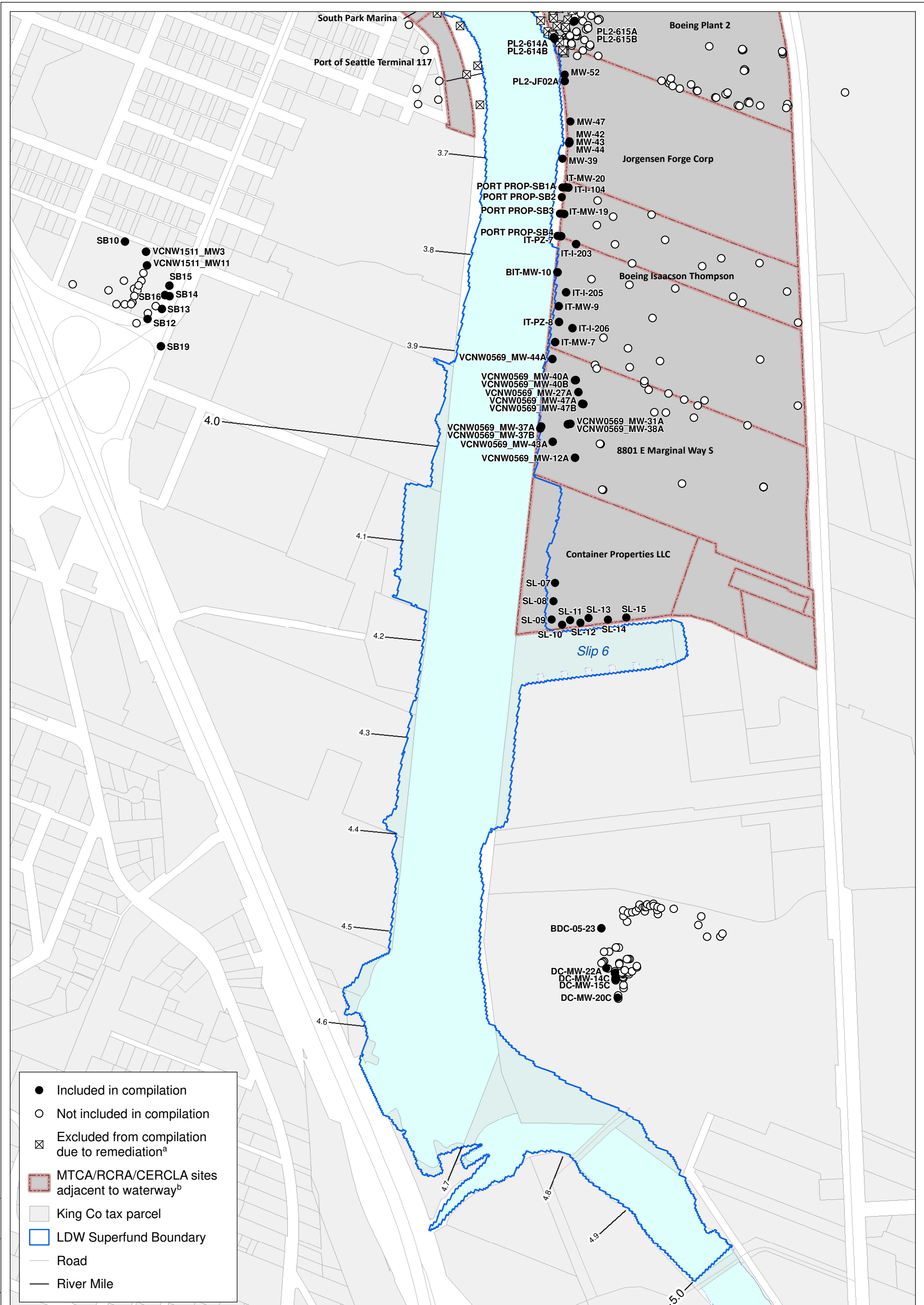

- Included in compilation
- Not included in compilation
- ⊠ Excluded from compilation due to remediation^a
- ▭ MTCA/RCRA/CERCLA sites adjacent to waterway^b
- ▭ King Co tax parcel
- ▭ LDW Superfund Boundary
- Road
- River Mile

^a Remediation status as reported for Boeing Plant 2 and T-117.
^b LDW TCP cleanup sites and EPA led cleanup sites as listed by WA Dept of Ecology Toxics Cleanup Program, 2018-01-11: <https://ecology.wa.gov/Spills-Cleanup/Contamination-cleanup/Cleanup-sites/Toxic-cleanup-sites/Lower-Duwamish-Waterway>. Note that negotiations for South Park Marina are underway.
 Note: In keeping with the Phase 1 RI approach (Windward 2003), the compilation included groundwater data that were collected from the most recent sampling event (since 2010) and from the wells that are closest to the shoreline. Data were not included in the compilation if the area has been remediated since it was last sampled.

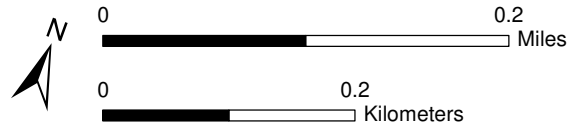

Map 2-6. Groundwater sampling locations assessed for data compilation in the Task 2 database, RM 3.8 to RM 5.0

Prepared by cragh, 8/13/2018, W:\Projects\Duwamish\AC03\GIS\Maps and Analysis\Task 2 Data Compilation Memo Map 2-6 8564e Groundwater well locations.mxd

Prepared by craigh. 8/2/2018. W:\Projects\Duwamish_AOC\GIS\Maps and Analyses\Task 02 Data Compilation Memo Map 3-1 6544 Surface sediment locations.mxd

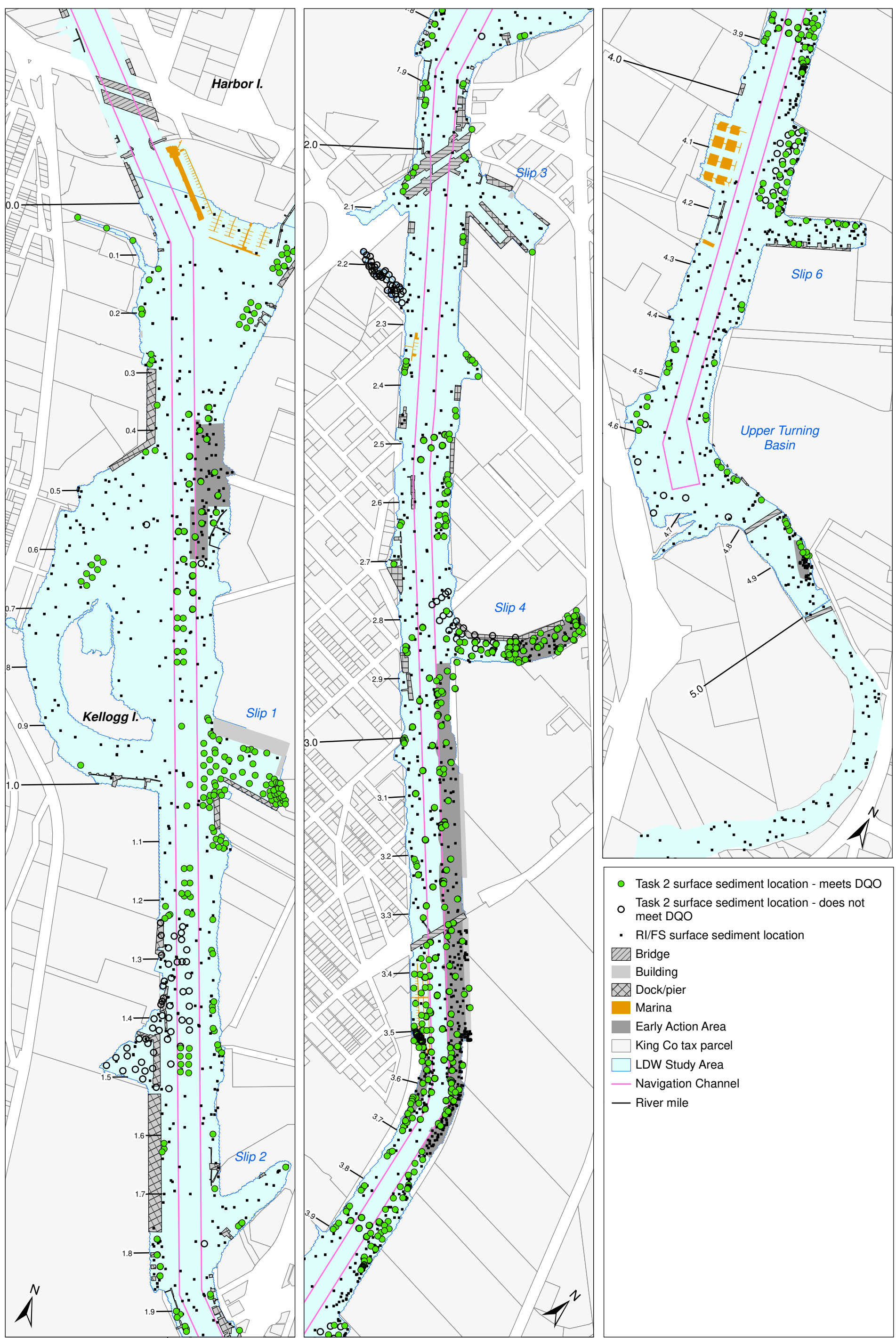

Windward
environmental LLC

Lower Duwamish Waterway Group
Port of Seattle / City of Seattle / King County / The Boeing Company

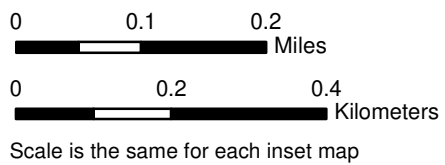

Map 3-1. Surface sediment sampling locations for in-waterway data compiled in the Task 2 database

Prepared by craigh. 8/2/2018. W:\Projects\Duwamish_AOC\GIS\Maps and Analyses\Task 02 Data Compilation Memo\Map 3-2 6545 Subsurface core locations.mxd

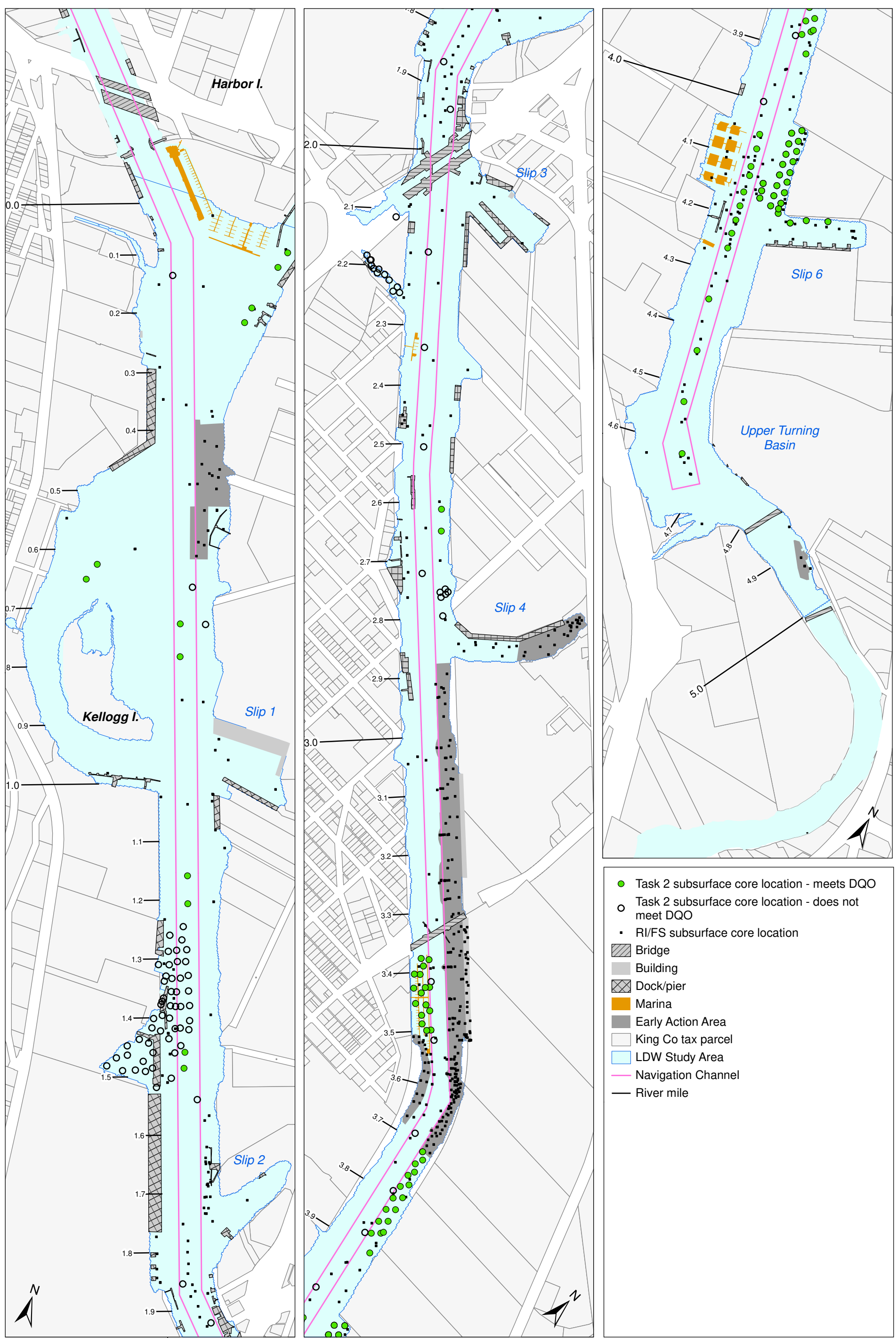

- Task 2 subsurface core location - meets DQO
- Task 2 subsurface core location - does not meet DQO
- RI/FS subsurface core location
- Bridge
- Building
- Dock/pier
- Marina
- Early Action Area
- King Co tax parcel
- LDW Study Area
- Navigation Channel
- River mile

Windward
environmental LLC

Lower Duwamish Waterway Group
Port of Seattle / City of Seattle / King County / The Boeing Company

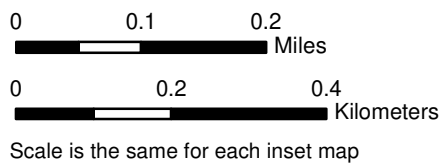

Map 3-2. Subsurface sediment sampling locations for in-waterway data compiled in the Task 2 database

Prepared by craigh. 8/2/2018. W:\Projects\Duwamish_AOC\GIS\Maps and Analyses\Task 02 Data Compilation Memo Map 3-3 6546 Surface water locations.mxd

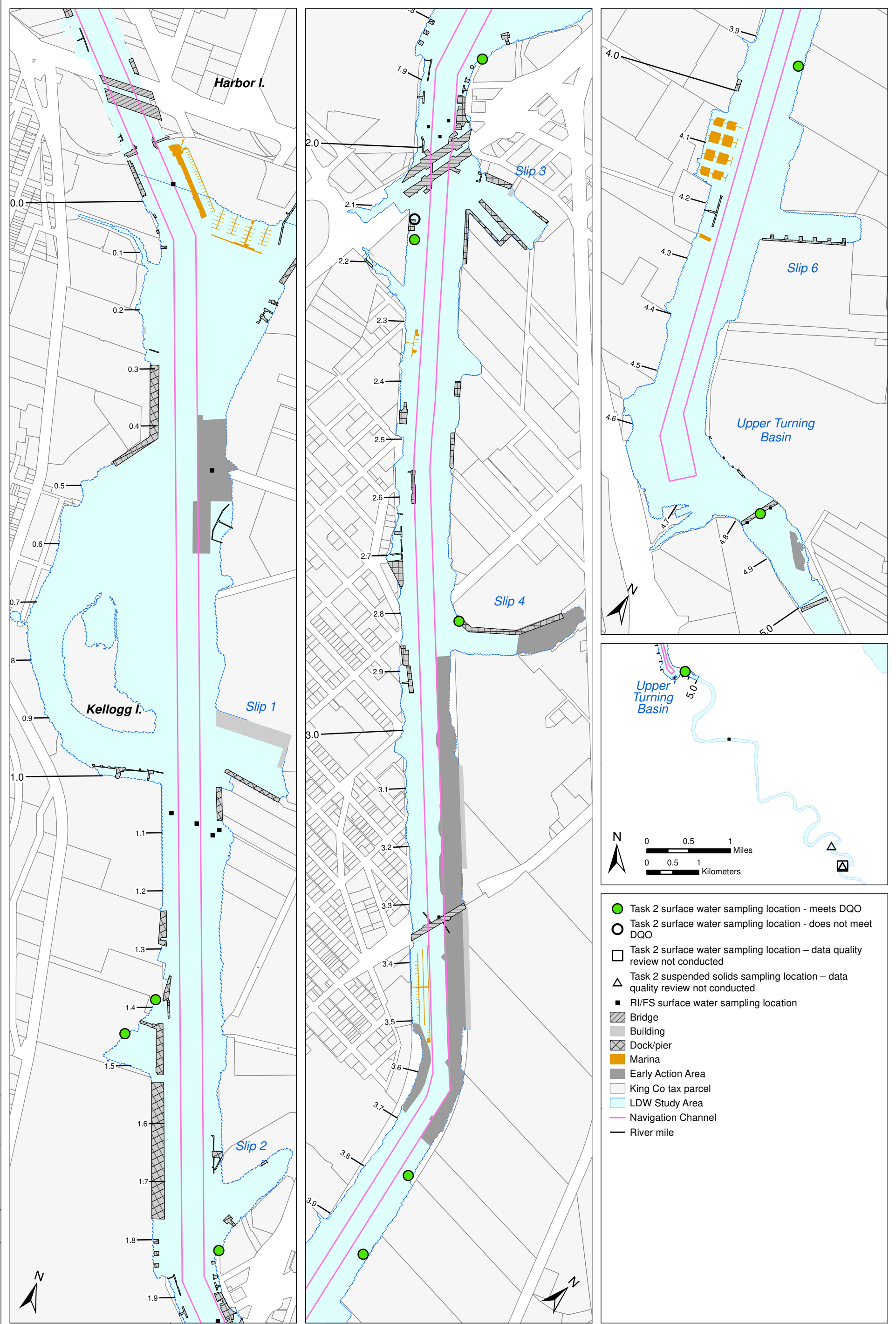

Windward
environmental LLC

Lower Duwamish Waterway Group
Port of Seattle / City of Seattle / King County / The Boeing Company

0 0.1 0.2 Miles
0 0.2 0.4 Kilometers
Scale is the same for each inset map

Map 3-3. Surface water sampling locations for in-waterway and Green/Duwamish River data compiled in the Task 2 database, including suspended solids locations for the Green/Duwamish River data

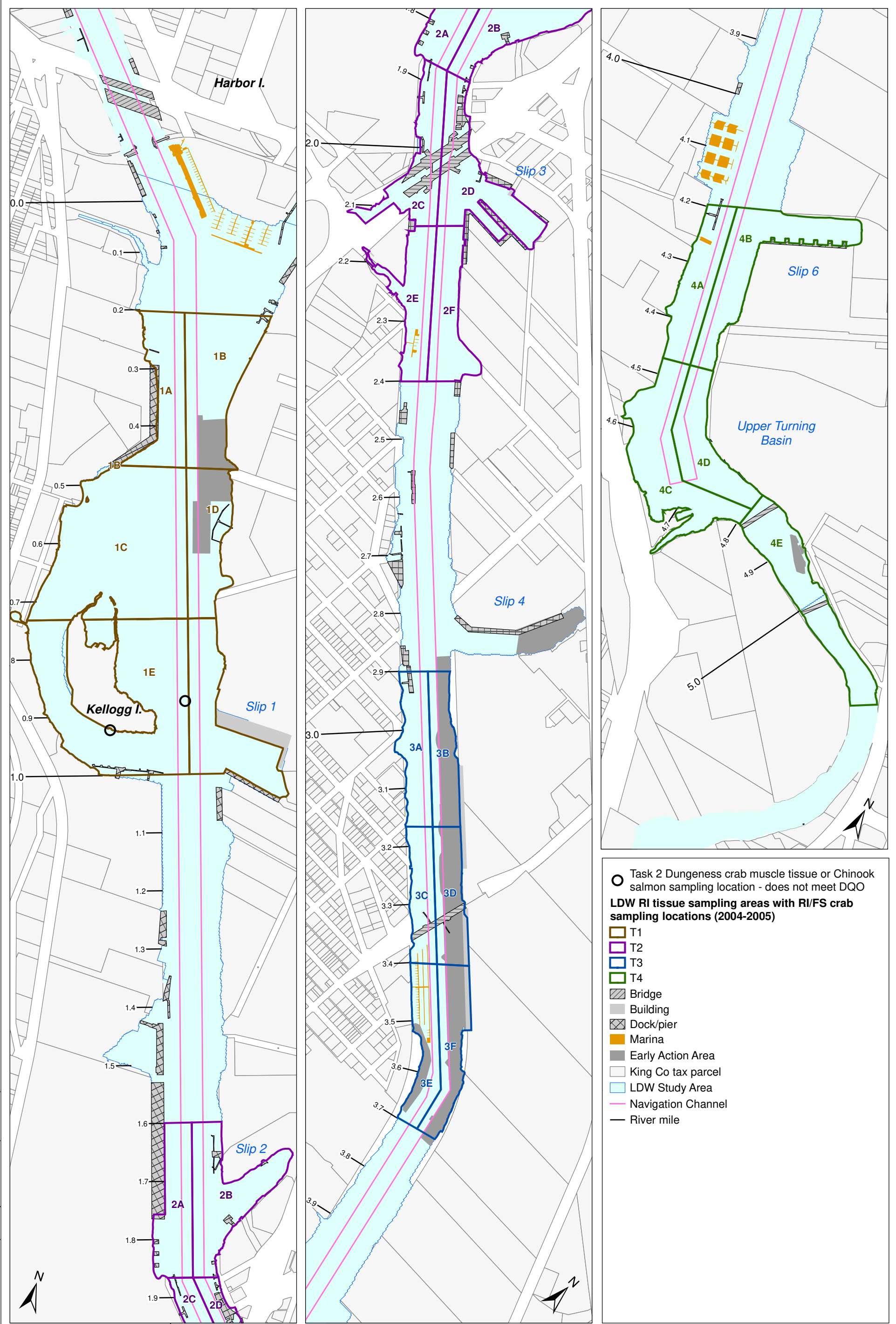

Lower Duwamish Waterway Group
 Port of Seattle / City of Seattle / King County / The Boeing Company

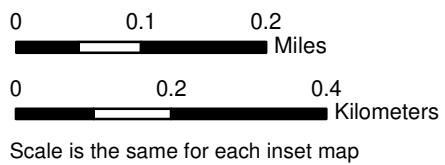

Map 3-4. Tissue sampling locations for in-waterway data compiled in the Task 2 database

Prepared by craigh. 8/2/2018. W:\Projects\Duwamish_AOC\GIS\Maps and Analyses\Task 02 Data Compilation Memo Map 3-5 6548 Porewater Locations.mxd

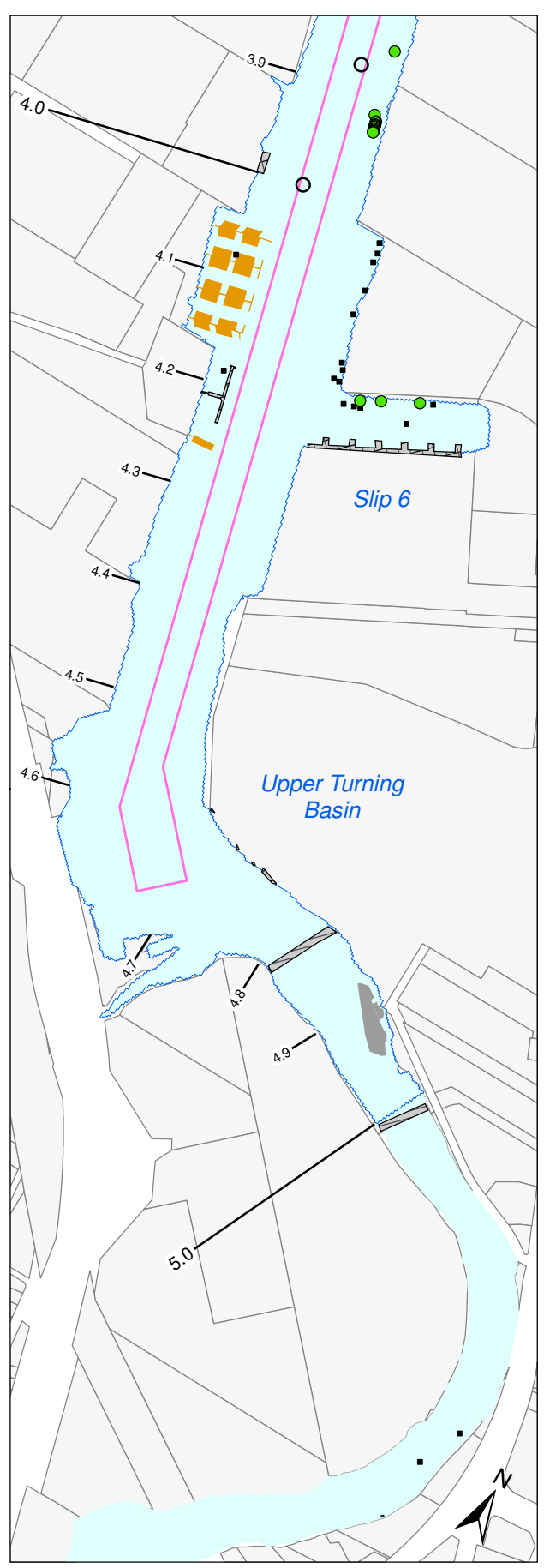
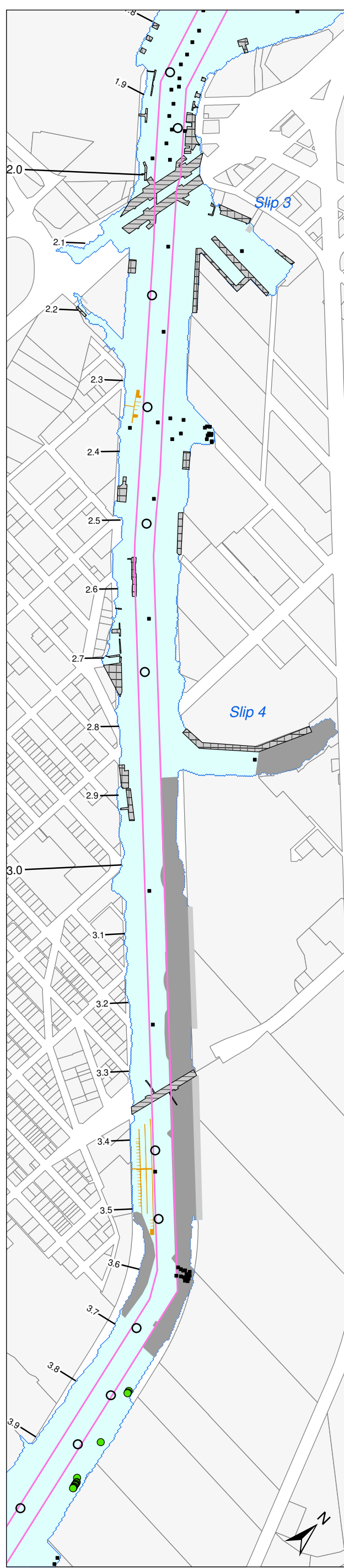
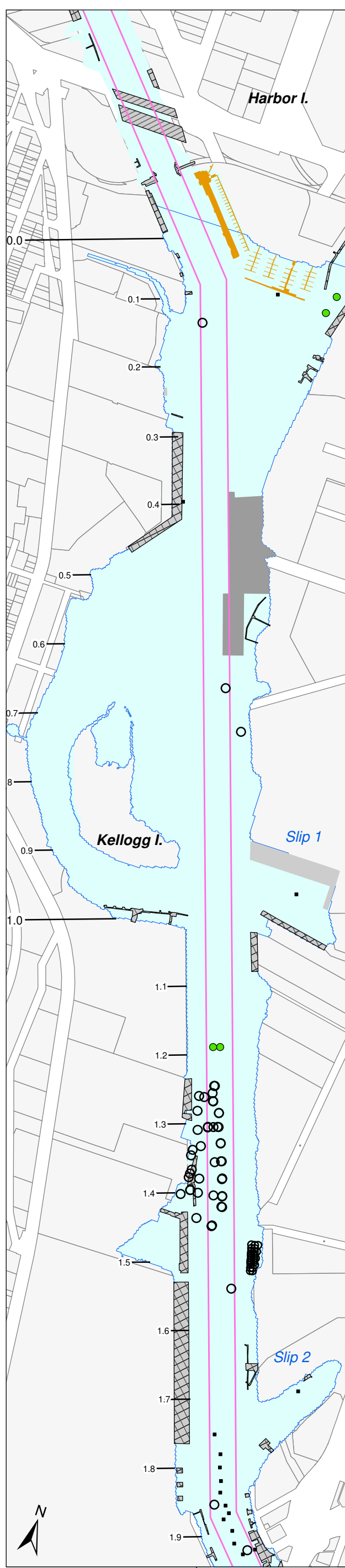

- Task 2 porewater sampling location - meets DQO
- Task 2 porewater sampling location - does not meet DQO
- RI/FS porewater sampling location
- Bridge
- Building
- Dock/pier
- Marina
- Early Action Area
- King Co tax parcel
- LDW Study Area
- Navigation Channel
- River mile

Windward
environmental LLC

Lower Duwamish Waterway Group
Port of Seattle / City of Seattle / King County / The Boeing Company

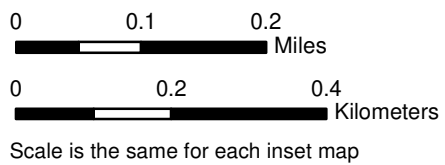

Map 3-5. Porewater sampling locations for in-waterway data compiled in the Task 2 database

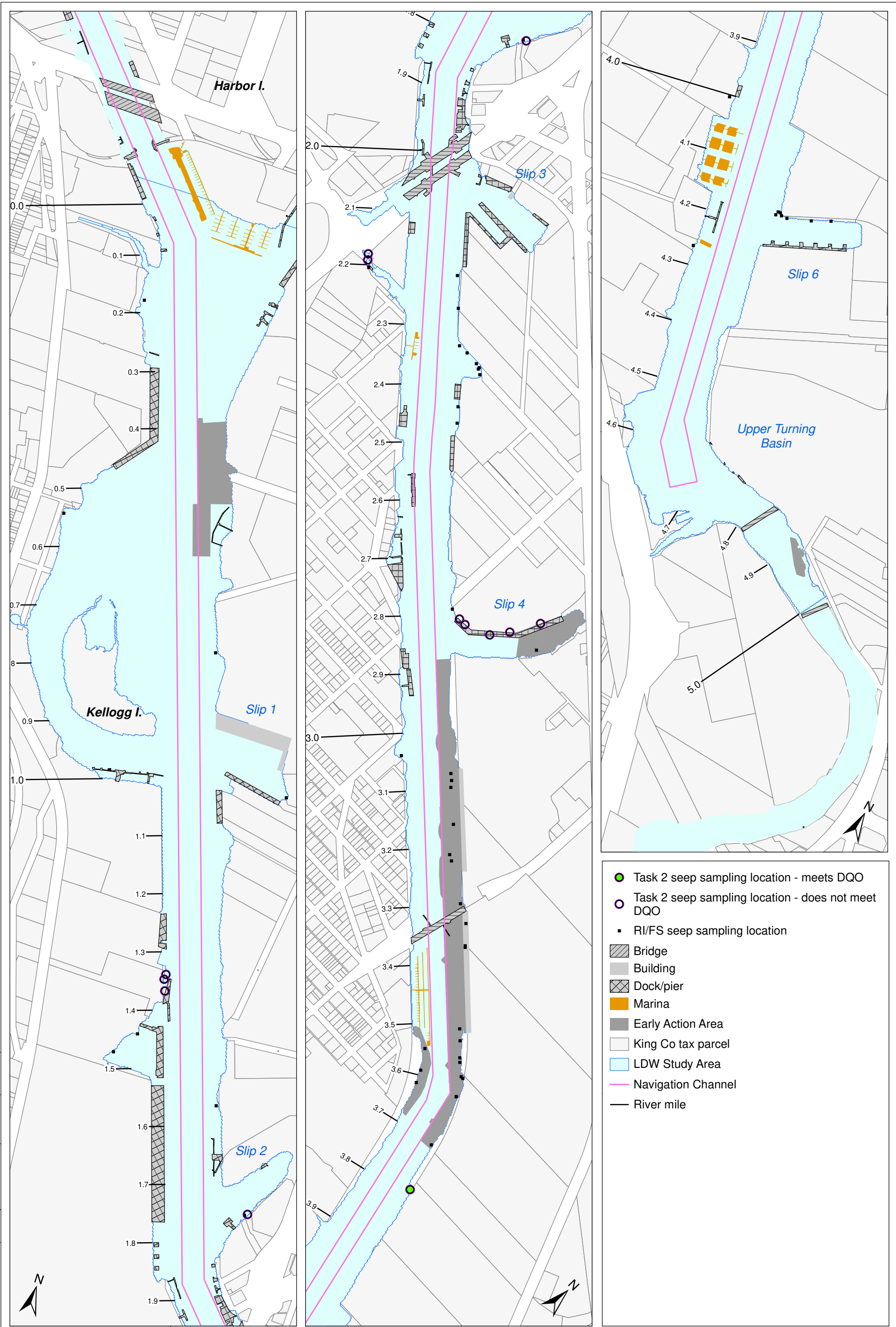

Map 3-6. Seep sampling locations for in-waterway data compiled in the Task 2 database

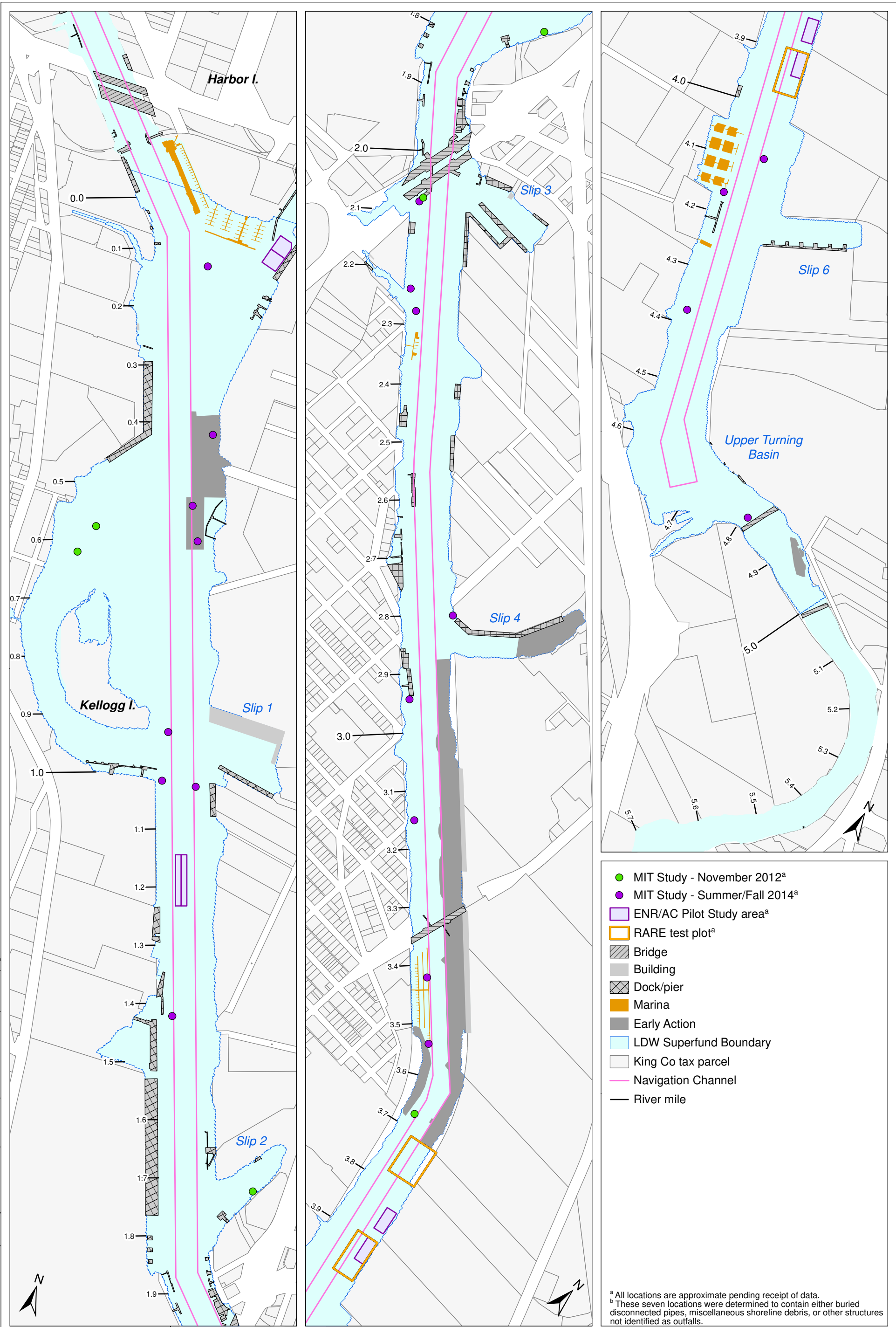

- MIT Study - November 2012^a
- MIT Study - Summer/Fall 2014^a
- ENR/AC Pilot Study area^a
- RARE test plot^a
- Bridge
- Building
- Dock/pier
- Marina
- Early Action
- LDW Superfund Boundary
- King Co tax parcel
- Navigation Channel
- River mile

^a All locations are approximate pending receipt of data.
^b These seven locations were determined to contain either buried disconnected pipes, miscellaneous shoreline debris, or other structures not identified as outfalls.

Map 5-1. Approximate porewater sampling locations in the MIT, ENR/AC Pilot, and RARE studies

